

State of Carolina
 Pursuant to a warrant from
 John Thomas Esq. Comr. of locations
 I have laid out unto Samuel
 Smith a tract of 492 acres of
 land in Ninety Six District
 on Fanner's Creek, and
 hath such shape, form
 and Marks, as the a
 bove Plat represents,
 Survey'd 5th Jan'y. 1787,

Charles Sims D.S.
 Recorded 8th Jan'y. 1787,

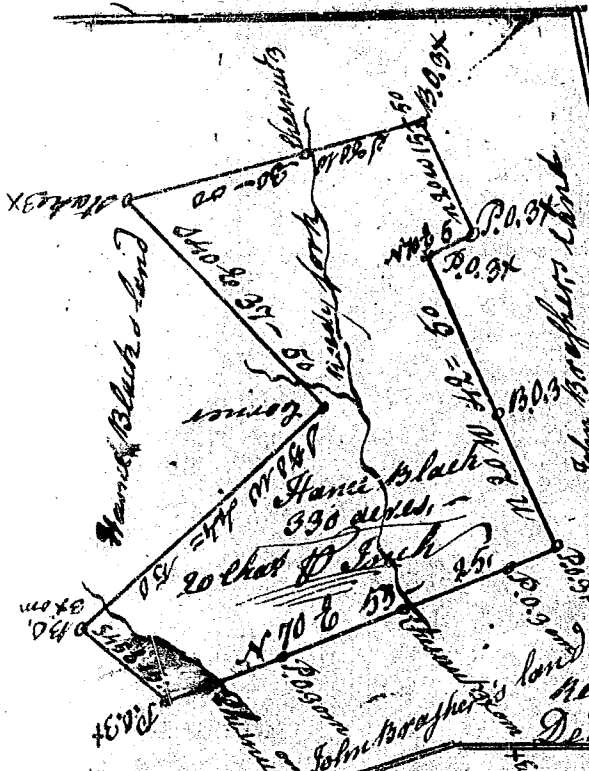

State of Carolina
 Pursuant to a warrant from John
 Thomas Esq. Comr. of locations Dated
 1st Sept. 1786, I have admeasured and
 laid out unto Jane Black a tract of
 Three Hundred and Thirty acres of
 land in 96 district on the S.W. side of
 Needy River, on a branch thereof called
 the Needy fork, and hath such form,
 Marks, buttings & boundings as the a
 bove Plat represents, Survey'd 10th Sept. 1786
 Recorded 9th Jan'y 1787. — by John Sims D.S.
 Del. self.

State of South Carolina
 Pursuant to a warrant from
 John Thomas Esq. Comr. of locations
 in 96 district & Saluda. I have
 surveyed and laid out unto Jesse
 Moody a tract of 241 acres of land
 including the head of a branch of
 the Needy fork of Needy River, and
 hath Boundaries, Marks & Shays, as the
 above Plat represents, Survey'd 28th Sept. 1786
 74
 by James Seaborn Esq
 Recorded 9th Jan'y 1787, Del. mt. black

